

Parallel grippers HGPC



Parallel grippers HGPC

Key features

At a glance

General

The compact and low-cost parallel gripper consists of a two-part symmetrical housing. The piston moves traverse to the half-shell casing in an optimum housing design that

guarantees reliable operation, long service life and convenient sensing. The gripper jaws move along the half shells in backlash-free, preloaded ball bearing guides.

- Double-acting gripper
- Compression spring for supplementary or retaining gripping forces
- Internal fixed flow control, does away with the need for external flow control in 80% of applications
- High force with minimal volume
- Suitable for external and internal gripping
- Wide range of options for attaching drive units
- Repetition accuracy of 0.05 mm
- Slot for proximity sensor SME/SMT-10

-  - Note

Sizing software
Gripper selection
→ www.festo.com

Details

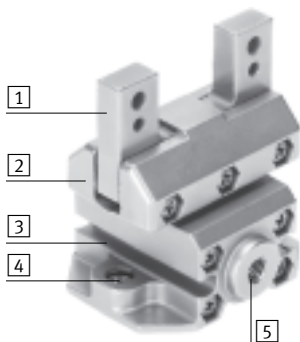

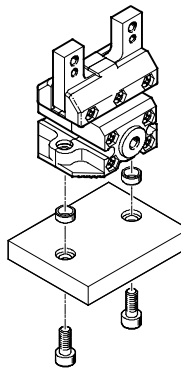

- 1 Gripper jaw with ball bearing guide
- 2 Housing based on half-shell principle
- 3 Slot for proximity sensor, for sensing the piston position
- 4 Mounting option
- 5 Supply port

Mounting option from underneath

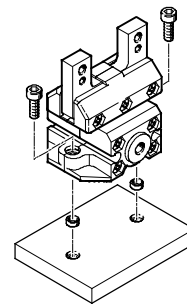

from above



-  - Note

Parallel grippers are not designed for the following applications:

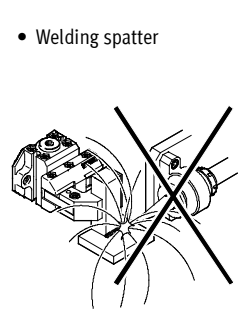
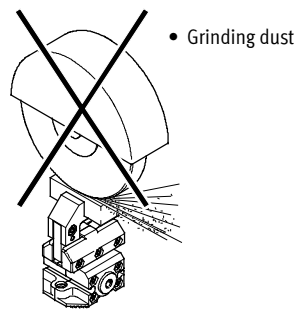
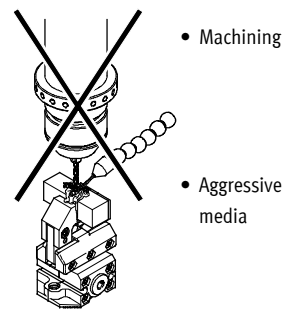

Parallel grippers HGPC

Peripherals overview and type codes

Peripherals overview

System product for handling and assembly technology

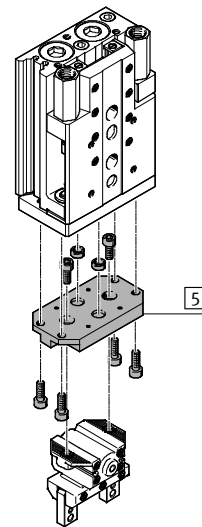
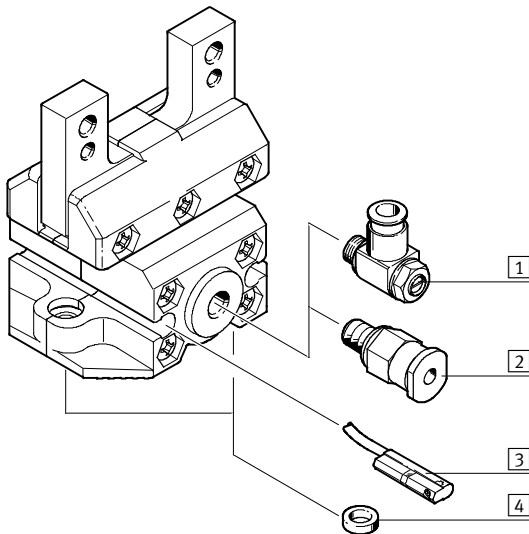

Accessories			
Type		Brief description	→ Page/Internet
1	One-way flow control valve GRLA	For regulating speed	gla
2	Push-in fitting QS	For connecting compressed air tubing with standard O.D.	quick star
3	Proximity sensor SME/SMT-10	For sensing the piston position	14
4	Centring sleeve ZBH	For centring when attaching to a drive (2 included in the scope of delivery)	14
5	Adapter kit HMSV, HAPG	Drive/gripper connections	12

Type codes

		HGPC	–	12	–	A	–	G2
Type								
HGPC	Parallel gripper							
Size								
Position sensing								
A	Via proximity sensor							
Gripping force backup								
G2	Closing							



Parallel grippers HGPC

Technical data

FESTO

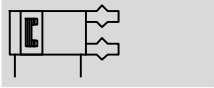
Function
Double-acting
HGPC-...-A



-  Size
12, 16, 20 mm
-  Stroke
6 ... 14 mm



Single-acting or
with gripping force retention
closing HGPC-...-G2



General technical data				
Size	12	16	20	
Constructional design	Wedge-shaped drive Guided motion sequence			
Mode of operation	Double-acting			
Gripper function	Parallel			
Number of gripper jaws	2			
Max. load per external gripper finger ¹⁾	[g]	20	50	80
Stroke per gripper jaw	[mm]	3	5	7
Pneumatic connection	M5			
Repetition accuracy ²⁾	[mm]	≤ 0.05		
Max. interchangeability	[mm]	≤ 0.2		
Max. gripper jaw backlash ³⁾	[mm]	0		
Max. gripper jaw angular backlash ⁴⁾	[°]	0		
Max. operating frequency	[Hz]	4		
Rotational symmetry	[mm]	< Ø 0.2		
Position sensing	For proximity sensing			
Type of mounting	With female thread and centring sleeve			
Mounting position	Any			

- 1) Valid for unthrottled operation
- 2) End-position drift under constant conditions of use with 100 consecutive strokes in the direction of movement of the gripper jaws
- 3) Perpendicular to the direction of motion of the gripper jaws
- 4) Pretensioned, backlash-free ball bearing guide

Operating and environmental conditions			
Min. operating pressure	HGPC-...-A	[bar]	2
	HGPC-...-G2	[bar]	4
Max. operating pressure		[bar]	8
Operating medium	Compressed air in accordance with ISO 8573-1:2010 [7:4:4]		
Note on operating/pilot medium	Operation with lubricated medium possible (in which case lubricated operation will always be required)		
Ambient temperature ¹⁾		[°C]	+5 ... +60
Corrosion resistance class CRC ²⁾			2

- 1) Note operating range of proximity sensors
- 2) Corrosion resistance class 2 according to Festo standard 940 070
Components requiring moderate corrosion resistance. Externally visible parts with primarily decorative surface requirements which are in direct contact with a normal industrial environment or media such as coolants or lubricating agents

Weights [g]			
Size	12	16	20
HGPC-...-A	152	241	473
HGPC-...-G2	154	244	477

Parallel grippers HGPC

Technical data

Materials

Sectional view

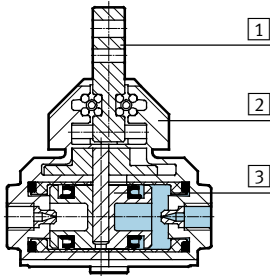

Parallel gripper		
1	Gripper jaw	High-alloy steel
2	Housing	Die-cast zinc
3	Piston	Polyamide
-	Seals	Polyurethane, nitrile rubber
-	Note on materials	Copper, PTFE and silicone-free Conforms to RoHS

Gripping force [N] at 6 bar

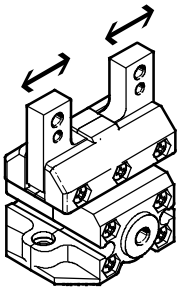

Size	12	16	20
Gripping force per gripper jaw			
Opening	22	41.5	63
Closing	22	41.5	63
Total gripping force			
Opening	44	83	126
Closing	44	83	126

Static characteristic load values at the gripper jaws

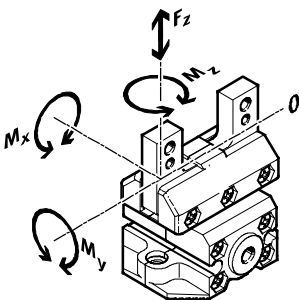

Indicated permissible forces and torques apply to a single gripper jaw. The indicated values include the lever arm, additional applied loads caused by the workpiece or external gripper

fingers, as well as forces which occur during movement. The zero coordinate line (gripper finger guide) must be taken into consideration for the calculation of torques.

Size	12	16	20	
Max. permissible force F_z	[N]	40	80	120
Max. permissible torque M_x	[Nm]	1	2,5	5
Max. permissible torque M_y	[Nm]	1	2,5	5
Max. permissible torque M_z	[Nm]	1	2,5	5

Parallel grippers HGPC

Technical data

Mass moment of inertia [kgm²x10⁻⁴]

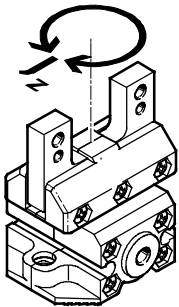

Mass moment of inertia [kgm²x10⁻⁴] of the parallel gripper in relation to the central axis with no load.

Size	12	16	20
HGPC-...-A	0.272	0.679	2.095
HGPC-...-G2	0.274	0.683	2.105

Opening and closing times [ms] at 6 bar

without external gripper fingers

with external gripper fingers

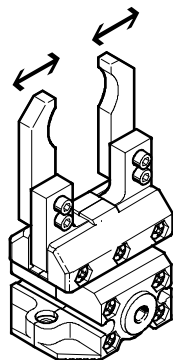
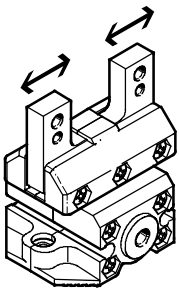

The indicated opening and closing times [ms] have been measured at room temperature and at 6 bar operating pressure with horizontally mounted gripper without additional

gripper fingers. The grippers must be throttled for greater loads [g]. Opening and closing times must then be adjusted correspondingly.

Size		12	16	20
without external gripper fingers				
HGPC-...-A	Opening	30	60	90
	Closing	30	60	90
HGPC-...-G2	Opening	30	70	105
	Closing	30	50	75
with external gripper fingers as a function of the load				
HGPC-...	40 g	40	-	-
	50 g	60	-	-
	60 g	80	-	-
	70 g	-	80	-
	100 g	-	100	-
	120 g	-	-	100

Parallel grippers HGPC

Technical data

Gripping force F_{Grip} per gripper jaw as a function of operating pressure and lever arm x

Gripping forces as a function of the operating pressure and the lever arm can be determined for the size using the following graph.

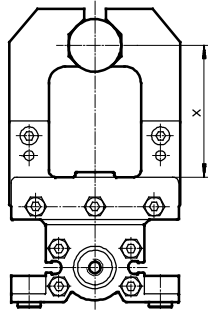

HGPC-12-A

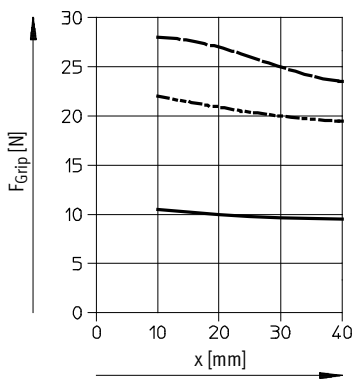

HGPC-16-A

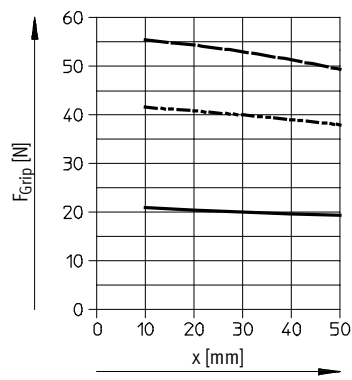

HGPC-20-A

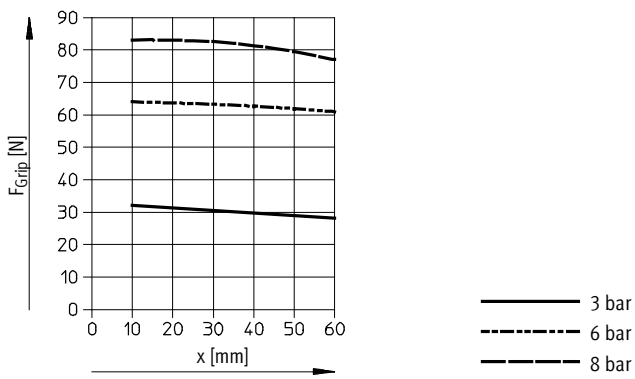

Parallel grippers HGPC

Technical data

Spring force F_S as a function of the gripper size and the overall stroke l

Gripping force retention for HGPC-...-G2

Spring forces F_S as a function of the gripper size and the overall stroke l for various gripper types (HGPC-...-G2) can be determined using the following graphs.

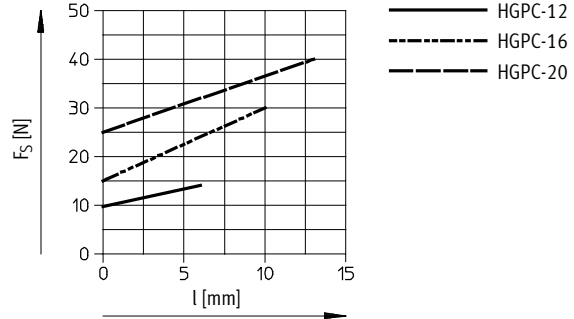
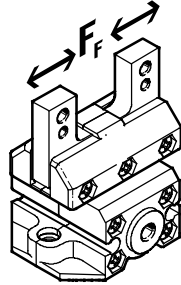

The lever arm x must be taken into consideration when determining the actual spring force F_{Stotal} . The formulae for calculating the spring force are provided in the table opposite.

Size	$F_{Stotal} =$
12	$-0.02 * x + 0.5 * F_S$
16	$-0.05 * x + 0.5 * F_S$
20	$-0.05 * x + 0.5 * F_S$

Determination of the actual gripping forces F_{Gr} for HGPC-...-G2 depending on the application

Parallel grippers with integrated spring type HGPC-...-G2 (closing gripping force retention) can be used as:
 – single-acting grippers

- grippers with supplementary gripping force
- grippers with gripping force retention

In order to calculate available gripping forces F_{Gr} (per gripper jaw), the gripping force (F_{Grip}) and spring

force (F_{Stotal}) must be combined accordingly.

Application

Single-acting	Supplementary gripping force	Gripping force retention
<ul style="list-style-type: none"> • Gripping with spring force: $F_{Gr} = F_{Stotal}$ • Gripping with pressure force: $F_{Gr} = F_{Grip} - F_{Stotal}$ 	<ul style="list-style-type: none"> • Gripping with pressure and spring force: $F_{Gr} = F_{Grip} + F_{Stotal}$ 	<ul style="list-style-type: none"> • Gripping with spring force: $F_{Gr} = F_{Stotal}$

Parallel grippers HGPC

Technical data

Gripping force F_{Grip} per gripper jaw at 6 bar as a function of lever arm x and eccentricity y

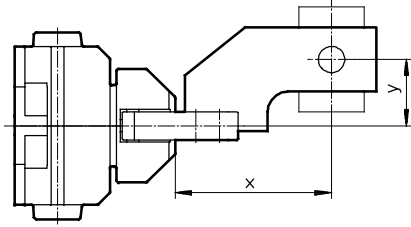

Gripping forces at 6 bar dependent upon eccentric application of force and the maximum permissible off-centre point of force application can be determined for the size using the following graph.

Calculation example

Given:

Lever arm $x = 20$ mm

Eccentricity $y = 22$ mm

To be found:

Gripping force at 6 bar

Procedure:

- Determine the intersection xy between lever arm x and eccentricity y in the graph for HGPC-12-A...
- Draw an arc (with centre at origin) through intersection xy .
- Determine the intersection between the arc and the X axis.
- Read the gripping force.

Result:

Gripping force $F =$ approx. 20.5 N

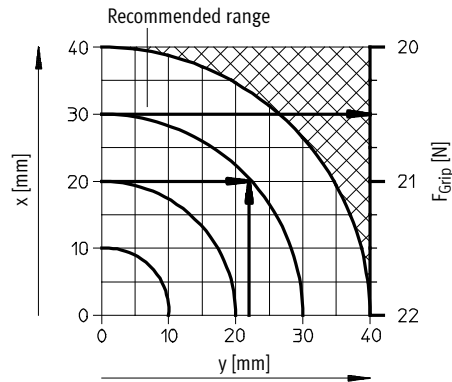

HGPC-12-A

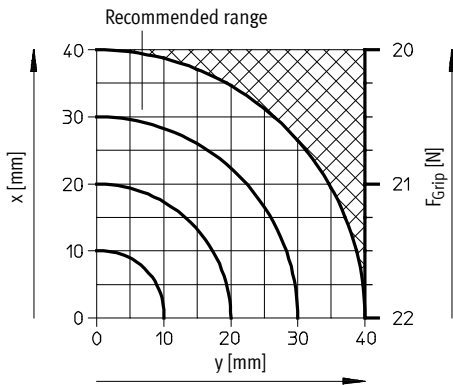

HGPC-16-A

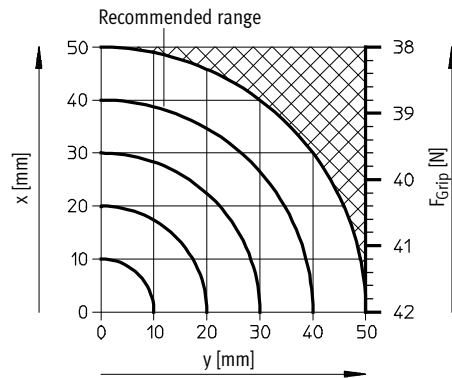

HGPC-20-A

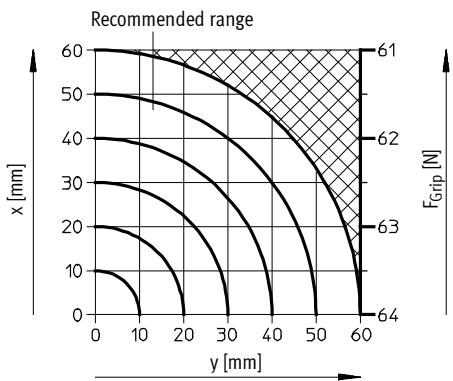

Parallel grippers HGPC

Technical data

FESTO

Dimensions

Download CAD data → www.festo.com

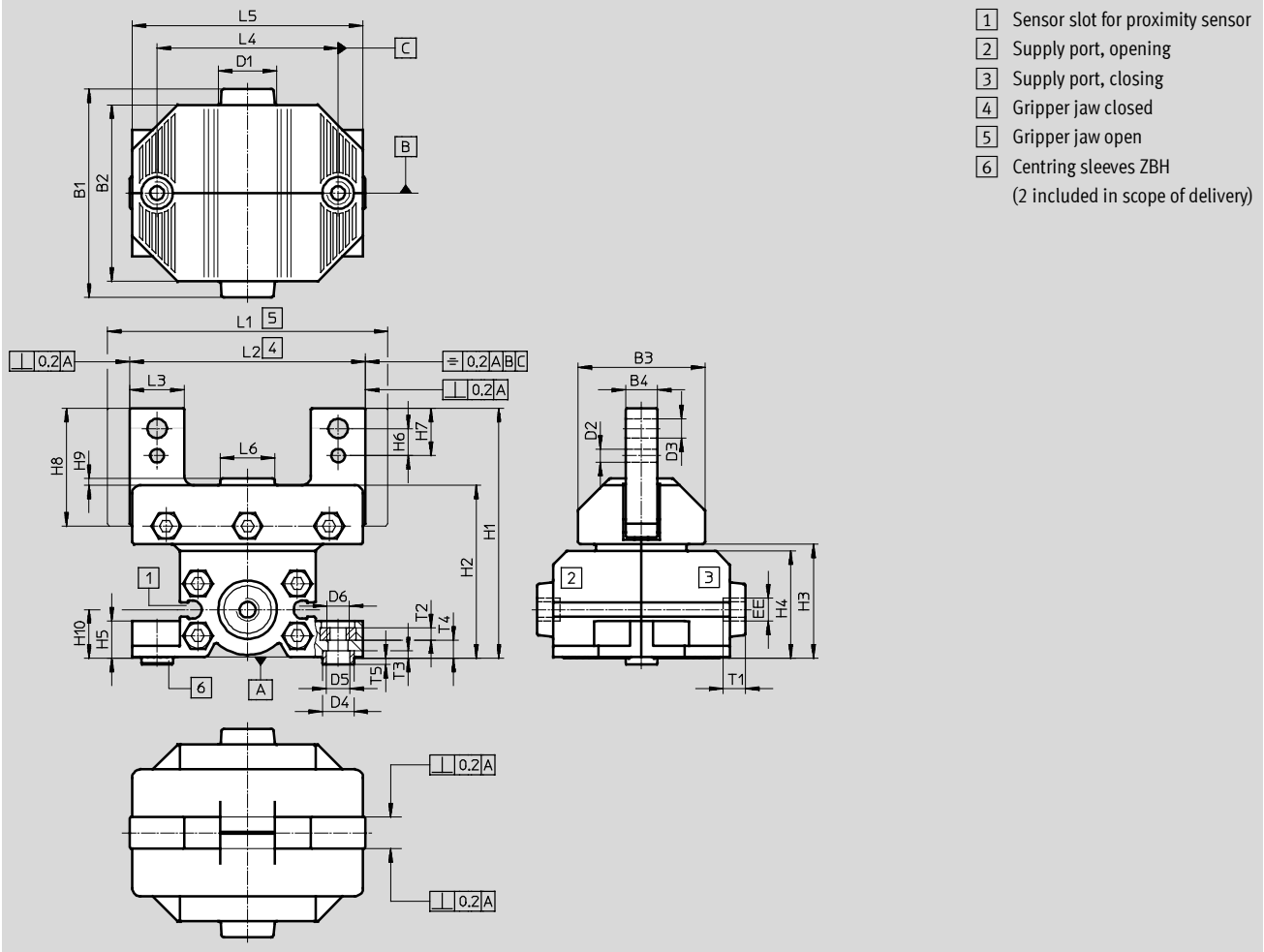

Size	B1	B2	B3	B4	D1	D2	D3	D4	D5	D6
[mm]				±0.1			±0.1	∅ F10/h7	∅	
12	38	33	22.4	6	12	2.5 ^{+0.04/+0.01}	3.3	7	5.3	M4
16	46	39	28	7	12	3 ^{H8}	4.3	7	5.3	M5
20	57	50	35	8	12	4 ^{H8}	5.3	9	6.4	M6

Size	EE	H1	H2	H3	H4	H5	H6	H7	H8	H9	H10
[mm]		±0.5							-0.2		
12	M5	48.2	33.6	21.7	20.2	6.9	5 ^{+0.05/-0.1}	9 ^{+0.05/-0.1}	25	1.2	9.2
16	M5	55.2	38.2	25.2	23.7	8.2	6±0.1	10.5±0.4	28.5	1.5	10.7
20	M5	68.7	48.2	32.5	30.5	10.2	7.5±0.1	13±0.4	34.5	1.5	13.7

Size	L1	L2	L3	L4 ¹⁾	L5	L6	T1	T2	T3	T4	T5
[mm]	±0.5	±0.5					min.		±0.1	+0.4 -0.3	+0.1 -0.3
12	45	39	10 ^{-0.02/-0.06}	33	42	10	4.5	2.2	1.7	3.1	1.3
16	62	52	12 ^{-0.05}	40	51	12	4.5	2.7	1.8	3.8	1.2
20	77	63	14 ^{-0.05}	50	65	16	4.5	3.2	2.3	5.2	1.7

1) Tolerance for centring hole ±0.03
Tolerance for thread ±0.1

Parallel grippers HGPC

Technical data

FESTO

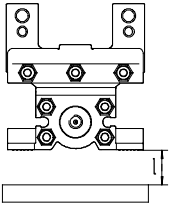

Minimum distance l between gripper and ferritic object				
		12	16	20
Distance	[mm]	10		

Ordering data				
	Size	Double-acting Without compression spring		Single-acting or with gripping force retention Closing
	[mm]	Part No.	Type	Part No. Type
	12	539 267	HGPC-12-A	539 268 HGPC-12-A-G2
	16	539 269	HGPC-16-A	539 270 HGPC-16-A-G2
	20	539 271	HGPC-20-A	539 272 HGPC-20-A-G2

Parallel grippers HGPC

Accessories

FESTO

Adapter kit
HAPG

Material:
Wrought aluminium alloy
Free of copper and PTFE
RoHS-compliant

 Note
The kit includes the individual mounting interface as well as the necessary mounting material.

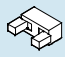
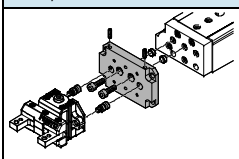
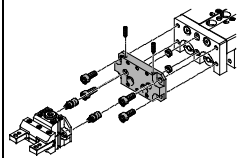
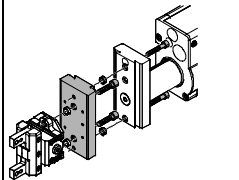
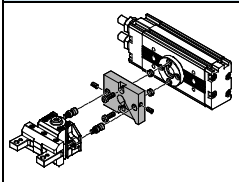
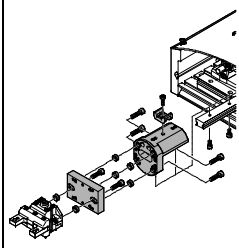
Permissible drive/gripper combinations with adapter kit							Download CAD data → www.festo.com	
Combination	Drive	Gripper	Mounting option		Adapter kit			
			Size	Size	CRC ¹⁾	Part No.	Type	
								
	DGSL	HGPC			HAPG			
	12, 16	12	■	■	2	529018	HAPG-58	
	20, 25	16	■	■		191267	HAPG-49	
	20, 25	20	■	■		191269	HAPG-51	
	SLT	HGPC			HAPG			
	10	12	■	–	2	542670	HAPG-100	
	16	12	■	–		529018	HAPG-58	
	16	16	■	–		542666	HAPG-101	
	20	16	■	–		191267	HAPG-49	
	20	20	■	–		542667	HAPG-102	
	25	20	■	–		191269	HAPG-51	
	HMP	HGPC			HAPG			
	16	16	–	■	2	191263	HAPG-45	
	20, 25	20	–	■		191264	HAPG-46	
	DRQD-...-FW	HGPC			HAPG			
	12, 16	12	■	■	2	542671	HAPG-SD2-41	
	16, 20	16	■	■		542668	HAPG-SD2-42	
	20	20	■	■		542669	HAPG-SD2-43	
	25	20	■	■		542758	HAPG-SD2-44	
	HSP	HGPC			HAPG			
	16	16	■	–	2	191901	HAPG-55	
						540882	HAPG-71-B	
	25	20	■	–		191901	HAPG-55	
						540883	HAPG-72-B	

1) Corrosion resistance class 2 according to Festo standard 940 070
Components subject to moderate corrosion stress. Externally visible parts with primarily decorative surface requirements which are in direct contact with a normal industrial environment or media such as coolants or lubricating agents.

Parallel grippers HGPC

Accessories



Adapter kit
HAPG

Material:
Wrought aluminium alloy
Free of copper and PTFE
RoHS-compliant

 Note
The kit includes the individual mounting interface as well as the necessary mounting material.

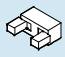
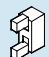
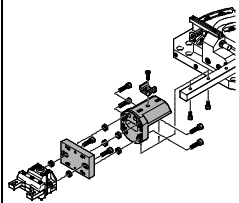
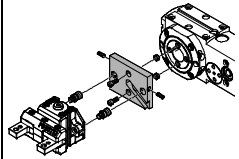
Permissible drive/gripper combinations with adapter kit						Download CAD data → www.festo.com	
Combination	Drive Size	Gripper Size	Mounting option		Adapter kit CRC ¹⁾	Part No.	Type
							
HSW/HGPC	HSW	HGPC	HAPG				
	12, 16	16	■	–	2	191901 540882	HAPG-55 HAPG-71-B
ERMB/HGPC	ERMB	HGPC	HAPG				
	20	16	■	■	2	542668	HAPG-SD2-42
	20	20	■	■		542669	HAPG-SD2-43
	25	20	■	■		542758	HAPG-SD2-44

1) Corrosion resistance class 2 according to Festo standard 940 070
Components subject to moderate corrosion stress. Externally visible parts with primarily decorative surface requirements which are in direct contact with a normal industrial environment or media such as coolants or lubricating agents.

Parallel grippers HGPC

Accessories



FESTO

Ordering data – Centring sleeves			Technical data → Internet: zbh		
	For size [mm]	Weight [g]	Part No.	Type	PU ¹⁾
	12, 16	1	186717	ZBH-7	10
	20	1	150927	ZBH-9	10

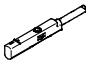
1) Packaging unit

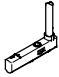
Ordering data – Proximity sensors for C-slot					
	Type of mounting	Electrical connection, connection direction	Switching output	Cable length [m]	Part No. Type
	N/O contact, magneto-resistive Technical data → Internet: smt				
	Insertable in the slot from above	Cable, 3-wire, in-line	PNP	2.5	551373 SMT-10M-PS-24V-E-2,5-L-OE
		Plug M8x1, 3-pin, in-line		0.3	551375 SMT-10M-PS-24V-E-0,3-L-M8D
	N/O contact, magnetic reed Technical data → Internet: sme				
Insertable in the slot lengthwise	Cable, 3-wire, in-line	Contacting	2.5	173210 SME-10-KL-LED-24	
	Plug M8x1, 3-pin, in-line		0.3	173212 SME-10-SL-LED-24	

Ordering data – Proximity sensors for C-slot					
	Type of mounting	Electrical connection, connection direction	Switching output	Cable length [m]	Part No. Type
	N/O contact, magneto-resistive Technical data → Internet: smt				
	Insertable in the slot from above	Cable, 3-wire, lateral	PNP	2.5	551374 SMT-10M-PS-24V-E-2,5-Q-OE
		Plug M8x1, 3-pin, lateral		0.3	551376 SMT-10M-PS-24V-E-0,3-Q-M8D
	N/O contact, magnetic reed Technical data → Internet: sme				
Insertable in the slot lengthwise	Cable, 3-wire, lateral	Contacting	2.5	173211 SME-10-KQ-LED-24	
	Plug M8x1, 3-pin, lateral		0.3	173213 SME-10-SQ-LED-24	

Ordering data – Connecting cables					Technical data → Internet: nebu
	Electrical connection, left	Electrical connection, right	Cable length [m]	Part No.	Type
	Straight socket, M8x1, 3-pin	Cable, open end, 3-wire	2.5	541333	NEBU-M8G3-K-2.5-LE3
			5	541334	NEBU-M8G3-K-5-LE3
	Angled socket, M8x1, 3-pin	Cable, open end, 3-wire	2.5	541338	NEBU-M8W3-K-2.5-LE3
			5	541341	NEBU-M8W3-K-5-LE3