

proximity sensor SIEA-M18B-UI-S

Part number: 538293
Product to be discontinued

FESTO

With plug, flush mounting

Type to be discontinued. Available until 2021. See Support Portal for alternative products.

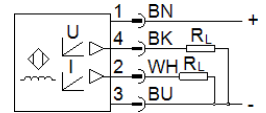
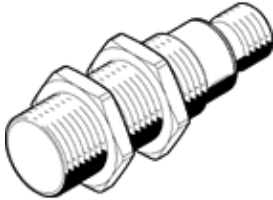

Data sheet

Feature	Value
Design	Round
Authorisation	RCM Mark c UL us - Listed (OL)
CE mark (see declaration of conformity)	to EU directive for EMC
Materials note	Free of copper and PTFE
Measuring principle	Inductive
Reduction factors	Aluminium = 0.18 Stainless steel, St 18/8 = 0.6 Copper = 0.15 Brass = 0.28 Steel, St 37 = 1.0
Distance measuring range	0 ... 10 mm
Ambient temperature	-25 ... 70 °C
Travel resolution	0.002 mm
Repetition accuracy	0.3 mm
Repetition accuracy for constant conditions	+/- 0,02 mm
Temperature drift from real switching distance	≤ ±10 %
Max. switching frequency, DC	500 Hz
Analogue output	0 - 10 V 4 - 20 mA
Bandwidth	500 Hz (-3 dB where s = 5 mm)
Max. load current at analogue voltage output	10 mA
Max. load at analogue voltage output	500 Ohm
Short circuit strength	Pulsing
Overload withstand capability	Available
Max. current/voltage output without object	120 %
Output voltage at 23°C	0 V / -0 + 0,4 V (s=0 mm) +5,2 V / ± 0,4 V (s=5 mm) +10 V / ± 0,4 V (s=10 mm)
Output current at 23°C	4mA / ± 0,8 mA (s=0 mm) 20mA / ± 0,8 mA (s=10 mm)
Operating voltage range DC	15 ... 30 V
Residual ripple	20 %
Idle current	≤ 10 mA
Polarity protected	for operating voltage
Electrical connection	Plug M12x1 4-pin
Size	M18
Mounting type	with lock nut
Tightening torque	25 Nm
Type of installation	flush

Feature	Value
Product weight	55 g
Material housing	Brass Chromed-plated
Protection class	IP67
Corrosion resistance classification CRC	2 - Moderate corrosion stress