

# proximity sensor SIEH-M18B-PS-S-L-CR

Part number: 538255

FESTO

Inductive, for large switching distances.

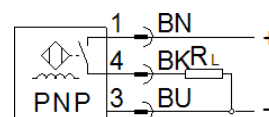
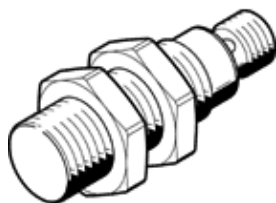

## Data sheet

Feature	Value
Conforms to standard	EN 60947-5-2
Authorisation	RCM Mark c UL us - Listed (OL)
CE mark (see declaration of conformity)	to EU directive for EMC
Materials note	Free of copper and PTFE
Nominal switching distance	10 mm
Guaranteed switching distance	8.1 mm
Reduction factors	Aluminium = 1.0 stainless steel 1 mm thick = 0.4 stainless steel 2 mm thick = 0.8 copper = 0.8 brass = 1.3 Steel, St 37 = 1.0
Ambient temperature	-25 ... 70 °C
Switch output	PNP
Switching element function	Normally open contact
Reproducibility, switching value FS	0.5 mm
Hysteresis	≤ 1.22 mm
Max. switching frequency	200 Hz
Max. output current	200 mA
Voltage drop	2 V
Inductive protective circuit	Integrated output current < 100mA and switching frequency < 10Hz
Short circuit strength	Pulsing
Operating voltage range DC	10 ... 30 V
Residual ripple	20 %
Idle current	< 12 mA
Polarity protected	for all electrical connections
Electrical connection	3-pin M12x1 Plug
Size	M18
Mounting type	with lock nut
Type of installation	flush
Product weight	53 g
Material housing	High alloy steel
Operating status display	Yellow LED
Ambient temperature with flexible cable installation	-5 ... 70 °C
Protection class	IP67 IP69K
Sensor assembly pressure resistance	60 bar
Corrosion resistance classification CRC	2 - Moderate corrosion stress