

# linear/swivel clamp CLR-63-50-L-P-A-K11-R8

Part number: 535509

FESTO

clamping system with linear and swivel motion 90 degrees to the left.  
standard hole pattern according to ISO 21287. With dust and weld  
spatter protection.

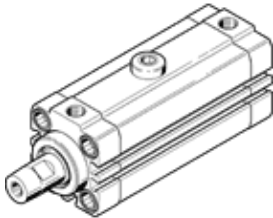

## Data sheet

Feature	Value
Total stroke	73 mm
Piston diameter	63 mm
Piston rod thread	M10
Swivel angle	90 deg +/- 2 deg
Clamping stroke	50 mm
Cushioning	P: Flexible cushioning rings/plates at both ends
Assembly position	Any
Design structure	Piston Piston rod Cylinder barrel
Position detection	For proximity sensor
Swivel direction	Left
Variants	spatter protection Dust protection
Operating pressure	2 ... 10 bar
Mode of operation	double-acting
Operating medium	Compressed air in accordance with ISO8573-1:2010 [7:4:4]
Note on operating and pilot medium	Lubricated operation possible (subsequently required for further operation)
Corrosion resistance classification CRC	2 - Moderate corrosion stress
Ambient temperature	-10 ... 80 °C
Effective clamping force at 2 bar	441 N
Effective clamping force at 4 bar	823 N
Effective clamping force at 6 bar	1,386 N
Max. tightening torque, tensioning finger screw	47 Nm
Theoretical clamping force at 6 bar	1,682 N
Product weight	2,625 g
Mounting type	with through hole with internal (female) thread with accessories Optional
Pneumatic connection	G1/8
Material wiper seal	PPS
Material of flange screw	Steel Galvanised
Material cover	Wrought Aluminium alloy coated
Material seals	NBR TPE-U(PU)
Material housing	Wrought Aluminium alloy Smooth anodised
Material piston rod	coated High alloy steel, non-corrosive
Material cylinder barrel	Wrought Aluminium alloy Smooth anodised