

linear/swivel clamp CLR-32-10-L-P-A-B-K11-R8

Part number: 535488

FESTO

clamping system with linear and swivel motion 90 degrees to the left.
standard hole pattern according to ISO 21287. With dust and weld
spatter protection.

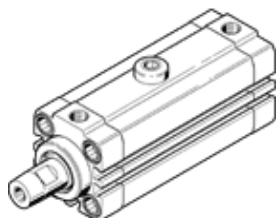

Data sheet

Feature	Value
Total stroke	28 mm
Piston diameter	32 mm
Piston rod thread	M8
Swivel angle	90 deg +/- 2 deg
Clamping stroke	10 mm
Cushioning	P: Flexible cushioning rings/plates at both ends
Assembly position	Any
Design structure	Piston Piston rod Cylinder barrel
Position detection	For proximity sensor
Swivel direction	Left
Variants	spatter protection Dust protection
Operating pressure	2 ... 10 bar
Mode of operation	double-acting
Operating medium	Compressed air in accordance with ISO8573-1:2010 [7:4:4]
Note on operating and pilot medium	Lubricated operation possible (subsequently required for further operation)
Corrosion resistance classification CRC	2 - Moderate corrosion stress
Ambient temperature	-10 ... 80 °C
Effective clamping force at 2 bar	111 N
Effective clamping force at 4 bar	216 N
Effective clamping force at 6 bar	313 N
Max. tightening torque, tensioning finger screw	24 Nm
Theoretical clamping force at 6 bar	362 N
Product weight	700 g
Mounting type	with through hole with internal (female) thread with accessories Optional
Pneumatic connection	G1/8
Material wiper seal	PPS
Material of flange screw	Steel Galvanised
Material cover	Wrought Aluminium alloy coated
Material seals	NBR TPE-U(PU)
Material housing	Wrought Aluminium alloy Smooth anodised
Material piston rod	coated High alloy steel, non-corrosive
Material cylinder barrel	Wrought Aluminium alloy Smooth anodised