

ball valve

VZBM-1/4-RP-40-D-2-F03-B2B3

Part number: 4405646

FESTO

Brass, 2/2-way, nominal width 1/4", top flange F03, PN40, thread EN 10226-1.

Festo is only a retailer of this product, not the manufacturer.

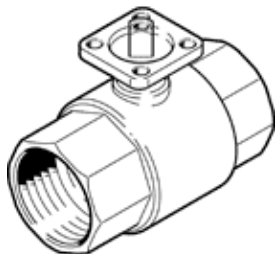

Data sheet

Feature	Value
Design structure	2-way ball valve
Type of actuation	mechanical
Sealing principle	soft
Assembly position	Any
Mounting type	Line installation
Process valve connection	Rp1/4
Switching position indicator	Slot direction = flow direction
Flange hole pattern	F03
Inside diameter	10 mm
Nominal diameter DN	8
Valve function	2/2
Flow direction	reversible
Nominal pressure of process valve	40
Breakaway torque at differential pressure, nominal pressure, process valve PN	3.2 Nm
Based on the standard	EN 10226-1 ISO 5211
Medium	Compressed air in accordance with ISO8573-1:2010 [-:--] Inert gases Water (no water vapour) Neutral fluids
Medium temperature	-20 ... 130 °C
Flow rate Kv	5.9 m ³ /h
Materials note	Contains PWIS substances Conforms to RoHS
Material housing	Brass Nickel plated
Material number for housing	CW617N
Material seals	HNBR PTFE
Material ball	Brass Chromed-plated
Material number for ball	CW614N
Material shaft	Brass
Material number for shaft	CW614N
Product weight	412 g
CE mark (see declaration of conformity)	to EU directive pressure devices
Corrosion resistance classification CRC	1 - Low corrosion stress