

# manifold block CPE10-PRSE-2

Part number: 164962

FESTO

For Compact Performance valves with closed PRS ducts.  
Only fittings with a G connection may be used with this manifold.

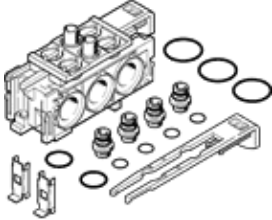

## Data sheet

Feature	Value
Max. number of valve positions	2
Operating medium	Compressed air in accordance with ISO8573-1:2010 [7:4:4]
Note on operating and pilot medium	Lubricated operation possible (subsequently required for further operation)
Corrosion resistance classification CRC	2 - Moderate corrosion stress
Product weight	40 g
Mounting method for sub-base	with through hole with top-hat rail
Pneumatic connection, port 1	G1/4
Materials note	Free of copper and PTFE Conforms to RoHS
Material housing	PA-reinforced