

freewheel unit FLSM-12-L

Part number: 164229

FESTO

for semi-rotary drive DSM.

These drives can be delivered on request with ATEX certification. The data on "ATEX identification", "ATEX ambient temperature" and "CE label" in the data sheet relate only to drives with certification.

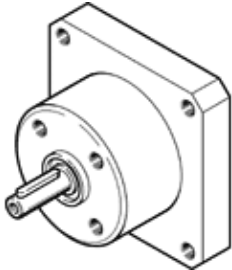

Data sheet

Feature	Value
Size	12
Direction of rotation	anti-clockwise rotation
Assembly position	Any
Ambient temperature	-10 ... 60 °C
Theoretical torque at 6 bar	1.2 Nm
Product weight	300 g
Material housing	Wrought Aluminium alloy
Material sleeve	Case-hardened steel
Material shaft	Case-hardened steel