

twin-piston cylinder

DPZJ-16-80-P-A-S2

Part number: 159949

FESTO

With two parallel, double-ended piston rods and yoke plates, for proximity sensing, with elastic cushioning rings in end positions.

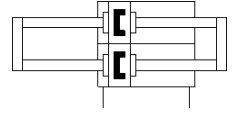
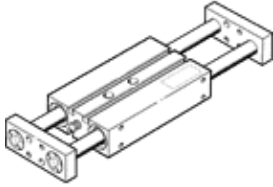

Data sheet

Feature	Value
Stroke	80 mm
Adjustable end-position range/length	10 mm
Piston diameter	16 mm
Operating mode of drive unit	Yoke
Cushioning	P: Flexible cushioning rings/plates at both ends
Assembly position	Any
Guide	Plain-bearing guide
Design structure	Guide
Position detection	For proximity sensor
Variants	Through piston rod
Operating pressure	1 ... 10 bar
Max. speed	1 m/s
Mode of operation	double-acting
Operating medium	Compressed air in accordance with ISO8573-1:2010 [7:4:4]
Note on operating and pilot medium	Lubricated operation possible (subsequently required for further operation)
Corrosion resistance classification CRC	2 - Moderate corrosion stress
Ambient temperature	-20 ... 80 °C
Impact energy in end positions	0.15 Nm
Theoretical force at 6 bar, return stroke	180 N
Theoretical force at 6 bar, advance stroke	180 N
alternative connections	See product drawing
Pneumatic connection	M5
Material cover	Wrought Aluminium alloy
Material seals	NBR
Material housing	Wrought Aluminium alloy
Material piston rod	High alloy steel, non-corrosive