

# servo motor EMMS-AS-140-LK-HV-RSB-S1

Part number: 1574709

FESTO

Without gear unit.

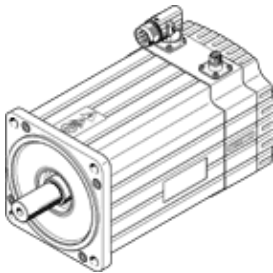

## Data sheet

Feature	Value
Ambient temperature	-10 ... 40 °C
Storage temperature	-20 ... 60 °C
Relative air humidity	0 - 90 %
Conforms to standard	IEC 60034
Insulation protection class	F
Rating class according to EN 60034-1	S1
Temperature monitoring	PTC resistor
Protection class	IP65
Shaft design Featherkey	DIN 6885 A 8 x 7 x 40
Electrical connector system	Plug
Materials note	Conforms to RoHS
Corrosion resistance classification CRC	2 - Moderate corrosion stress
Authorisation	RCM Mark c UL us - Recognized (OL)
CE mark (see declaration of conformity)	to EU directive for EMC to EU directive low-voltage devices
Nominal voltage DC	565 V
Type of winding switch	Star inside
Number of pole pairs	6
Standstill torque	25.5 Nm
Nominal torque	17.41 Nm
Peak torque	67.5 Nm
Nominal rotary speed	2,800 1/min
Max. speed	3,830 1/min
Nominal motor power	5,110 W
Nominal motor current	9.96 A
Peak current	51.5 A
Motor constant	1.75 Nm/A
Voltage constant, phase-to-phase	104.41 mV/min
Phase-phase winding resistance	0.586 Ohm
Phase-phase winding inductance	4.65 mH
Overall mass moment of inertia at power take-off	20.108 kgcm <sup>2</sup>
Product weight	17,000 g
Permissible axial shaft load	200 N
Permissible radial shaft load	1,060 N
Rotor position sensor	Absolute single turn encoder
Rotary position encoder interface	EnDat 22
Rotary position encoder measuring principle	Inductive
Rotary position encoder resolution	18 Bit
Brake holding torque	18 Nm
Operating voltage DC for brake	24 V
Power consumption, brake	15.6 W
Mass moment of inertia of brake	1.2 kgcm <sup>2</sup>
Switching cycles, holding brake	5 million idle actuations (without work of friction!)
MTTF, subcomponent	76 years, rotary position encoder 4469 years, holding brake
MTTFd, subcomponent	152 years, rotary position encoder