

semi-rotary drive DSM-T-12-270-CC-A-B

Part number: 1145088

FESTO

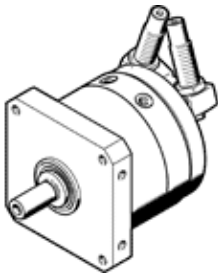

Data sheet

Feature	Value
Size	12
Cushioning angle	15 deg
Rotation angle adjustment range	0 ... 246 deg
Swivel angle	0 ... 246 deg
Cushioning	CC: Shock absorber at both ends
Assembly position	Any
Fine adjustment	-3 deg
Mode of operation	double-acting
Design structure	Rotary vane
Position detection	For proximity sensor
Operating pressure	2.5 ... 10 bar
Max. swivel frequency at 6 bar	1.5 Hz
Operating medium	Compressed air in accordance with ISO8573-1:2010 [7::-]
Corrosion resistance classification CRC	0 - No corrosion stress
Ambient temperature	-10 ... 60 °C
Max. axial force	18 N
Max. radial force	45 N
Theoretical torque at 6 bar	2.5 Nm
Permissible mass moment of inertia	0.008 kgm ²
Product weight	375 g
Mounting type	with internal (female) thread
Pneumatic connection	M5
Materials note	Free of copper and PTFE Conforms to RoHS
Material of drive shaft	Steel Nickel plated
Material seals	TPE-U(PU)
Material housing	Wrought Aluminium alloy